

RQS

Tubing clamp systems for light, medium and heavy duty applications

One-piece tubing clamp for medium and heavy applications with through hole for fastening by screws, ribbed fixing for strain relief, quick assembly, cover connected with integral hinge, assembly of varying sizes joined feasible, applicable in combination with C-profile bars, HB (UL 94)

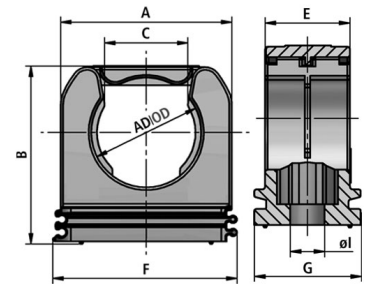

Temperature: -40°C ... +120°C

Material: PA plastics

CHARACTERISTICS:

- Properties: ribbed fixing for strain relief
- quick assembly by means of a film hinge
- assembly of varying sized joined in line
- for using in combination with C-profile bar
- free of silicone, cadmium, halogen
- fit for high mechanical stress
- impact-resistant

APPLICATIONS:

- Application: for medium and heavy duty applications / machine and plant constructions / insulated electrical installations for application rules machine and plant constructions acc. to DIN EN 60204



ELECTRO-PRODUCTS CORP.

| FLEXA No. | Colour | OD [mm] | A [mm] | B [mm] | C [mm] | E [mm] | F [mm] | G [mm] | Ø I [mm] | Weight [kg/100] | PU [pcs.] |
|-------------|--------|------------|-----------|-----------|-----------|-----------|-----------|-----------|-------------|--------------------|--------------|
| 15030020207 | Black | 10,0 | 21,0 | 23,5 | 8,5 | 16,0 | 23 | 20 | 5,5 | 0,470 | 50 |
| 15030020209 | Black | 13,0 | 25,0 | 25,0 | 9,2 | 16,0 | 27 | 20 | 5,5 | 0,640 | 50 |
| 15030020211 | Black | 15,8 | 27,0 | 27,0 | 11,2 | 16,0 | 29 | 20 | 6,5 | 0,700 | 50 |
| 15030020213 | Black | 17,8 | 31,0 | 31,5 | 12,7 | 16,0 | 32 | 20 | 6,5 | 0,880 | 50 |
| 15030020216 | Black | 21,2 | 33,0 | 34,0 | 16,1 | 16,0 | 35 | 20 | 6,5 | 0,940 | 50 |
| 15030020221 | Black | 28,5 | 40,0 | 40,5 | 20,5 | 16,0 | 42 | 20 | 6,5 | 1,000 | 25 |
| 15030020229 | Black | 34,5 | 46,0 | 46,9 | 25,7 | 16,0 | 48 | 20 | 6,5 | 1,390 | 25 |
| 15030020236 | Black | 42,5 | 55,0 | 55,0 | 30,0 | 16,0 | 57 | 20 | 6,5 | 1,770 | 25 |
| 15030020248 | Black | 54,5 | 65,5 | 69,5 | 38,0 | 17,0 | 69 | 20 | 6,5 | 2,450 | 10 |
| | | | | | | | | | | | |
| 15030020007 | Grey | 10,0 | 21,0 | 23,5 | 8,5 | 16,0 | 23 | 20 | 5,5 | 0,470 | 50 |
| 15030020009 | Grey | 13,0 | 25,0 | 25,0 | 9,2 | 16,0 | 27 | 20 | 5,5 | 0,640 | 50 |
| 15030020011 | Grey | 15,8 | 27,0 | 27,0 | 11,2 | 16,0 | 29 | 20 | 6,5 | 0,700 | 50 |
| 15030020013 | Grey | 17,8 | 31,0 | 31,5 | 12,7 | 16,0 | 32 | 20 | 6,5 | 0,880 | 50 |
| 15030020016 | Grey | 21,2 | 33,0 | 34,0 | 16,1 | 16,0 | 35 | 20 | 6,5 | 0,940 | 50 |
| 15030020021 | Grey | 28,5 | 40,0 | 40,5 | 20,5 | 16,0 | 42 | 20 | 6,5 | 1,100 | 25 |
| 15030020029 | Grey | 34,5 | 46,0 | 46,9 | 25,7 | 16,0 | 48 | 20 | 6,5 | 1,390 | 25 |
| 15030020036 | Grey | 42,5 | 55,0 | 55,0 | 30,0 | 16,0 | 57 | 20 | 6,5 | 1,770 | 25 |
| 15030020048 | Grey | 54,5 | 65,5 | 69,5 | 38,0 | 17,0 | 69 | 20 | 6,5 | 2,450 | 10 |

Recommendations for any areas of applications, products, or product combinations are issued to the best of FLEXA's knowledge and experience. The user is requested to check applicability of FLEXA products to specific applications and purposes prior to the use of the particular products. All documentation, illustrations, and charts published are subject to copyright and must not be copied, changed, used, or modified. Technical drawings, certificates, authorizations, and results by the FLEXA lab will be provided upon request. FLEXA will not be held liable for typographical or other errors and incorrect drawings. Technical modifications are subject to change without prior notice.